

**TDS1**  
**TDS Meter**  
*with*  
**Automatic**  
**Temperature**  
**Compensation**

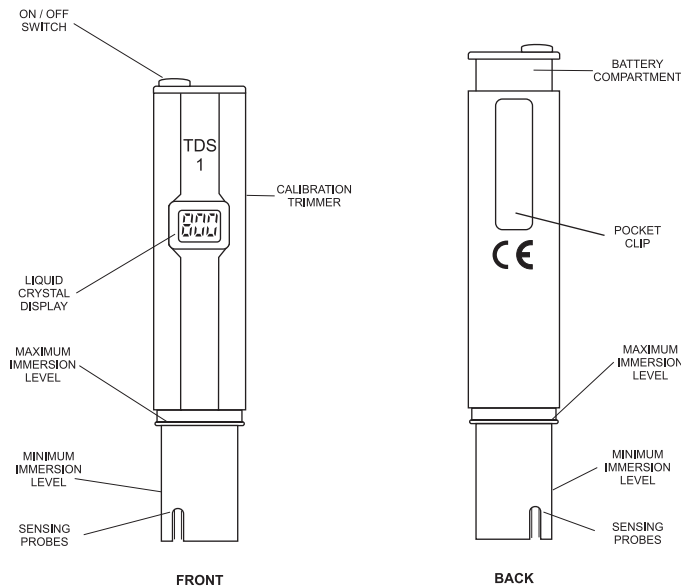

**HANNA**  
instruments

*Manufacturers since 1978*



### OPERATING:

- Remove the protective cap.

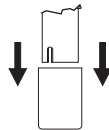

- Turn TDS1 on.

- Immerse the tester into solution up to the maximum immersion level without touching the bottom of the beaker.

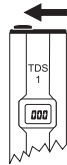

- Stir gently and wait until the display stabilizes. TDS1 automatically compensates for temperature variations.

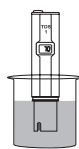

### CALIBRATION:

- Immerse the tester into HI 70080 (800 ppm @25°C/77°F) calibration solution, without exceeding the maximum level.

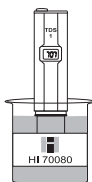

- Allow the reading to stabilize and using a small screwdriver adjust the calibration trimmer until the nominal ppm value of the

solution is displayed.

- Calibration is now complete.

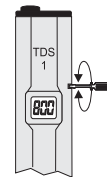

### BATTERY REPLACEMENT:

When the TDS1 can not be switched on or the display fades, batteries have to be replaced.

Pull out the batteries compartment and replace all four 1.5V batteries, while paying attention to their polarity.

Batteries should only be replaced in a non hazardous area using the battery types specified in this instruction manual.

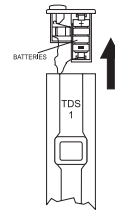

### RECOMMENDATIONS FOR USERS:

Before using this product, make sure that it is entirely suitable for the environment in which it is used. Operation of this instrument in residential areas could cause unacceptable interferences to radio and TV equipment. Any variation introduced by the user to the supplied equipment may degrade the instrument's EMC performance. To avoid electrical shocks, do not use this instrument when voltage at the measurement surface exceeds 24 VAC or 60 VDC. To avoid damages or burns, do not perform any measurement in microwave ovens.

# **TDS1**

## **TDS Meter**

**with**  
**Automatic**  
**Temperature**  
**Compensation**

### SPECIFICATIONS:

RANGE	0 to 999 ppm (mg/L)
RESOLUTION	1 ppm
ACCURACY (@20°C/68°F)	±2% f.s.
TYPICAL EMC DEVIATION	±1% f.s.
CALIBRATION	Manual, at one point through trimmer
CAL. SOLUTION	HI70080 800 ppm @25°C (77°F)
TEMP. COMPENSATION	Automatic from 5 to 50°C (41 to 122°F)
ENVIRONMENT	0 to 50°C (32 to 122°F); 95% RH
BATTERY TYPE	4 x 1.5V alkaline
BATTERIES LIFE	approx. 150 hours
DIMENSIONS	150 x 30 x 24 mm (5.9 x 1.2 x 0.9")
WEIGHT	85 g (3 oz.)

### ACCESSORIES:

HI 70080P	800 ppm calibration solution (25x20 mL sachets)
HI 731326	Calibration screwdriver (20pcs)

**Visit our Internet Home Page:**  
**<http://www.hannainst.com>**

